



MALARIA HRP2/pLDH(P.f/Pan)

Wondfo One Step Malaria HRP2/pLDH (P.f/Pan) Test cassette is a rapid self-performing, qualitative, two site sandwich immunoassay, utilizing whole blood for the detection of P.falciparum specific histidine rich protein-2 (P.f HRP-2) and Pan specific pLDH. The test may also be used for differentiation of P.falciparum and other malarial species in whole blood samples & for the follow up of anti-malarial therapy. For in vitro diagnostic use only. For healthcare professional use only.

General Information:

- Malaria P.falciparum and the other plasmodium with separate test line at one time
- Differential detection of P.falciparum and the other plasmodium
- Sensitivity : 99.6% for P.f, 95.9% for Non-P.f
- Specificity : 99.3%
- No instruments needed
- Specimen : whole blood
- Reading Time : 20 min
- Storage : 1~30°C

Product Features:

- Result is available in 20 minutes
- Simple to use
- Easy to read result
- Requires a little amount (5µL) of whole blood
- CE certificate



MALARIA AB P.f/P.v

Malaria Ab/P.f/P.v: A chromatographic immunoassay for the qualitative detection of antibodies of all isotype (IgG, IgM, IgA) specific to Plasmodium falciparum and Plasmodium vivax at the same time in human serum, plasma or whole blood.

General Information:

- Malaria Ab/P.f/P.v:
- Detect Malaria Ab P.f/P.v
- Specimen : Serum, plasma, whole blood
- Relative serological Sensitivity : 90% (99/110)
- Relative serological Specificity : 99.1% (218/220)
- No instruments needed
- Reading time : 15~20 min
- Storage : 1~30°C

Product Features:

- Result is available in 15 minutes
- Simple test procedure
- CE certificate



Test Procedure:

Allow the device, buffer and specimen to equilibrate to room temperature (10°C ~30°C) prior to testing.

1. Remove the test cassette from the foil pouch by tearing at the notch and place it on a level surface.
2. Slowly add 5 µl of whole blood to the sample well (A) and then add 4 drops (90~100ul) of clearing buffer to the buffer well (B).
3. As the test begins to work, you will see purple color move across the result window in the center of the test device.
4. Wait for 15 minutes and read results. Do not read results after 30 minutes.

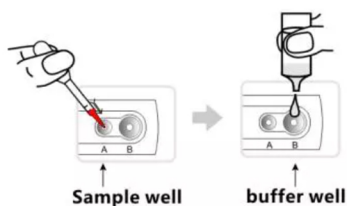

Read Results:

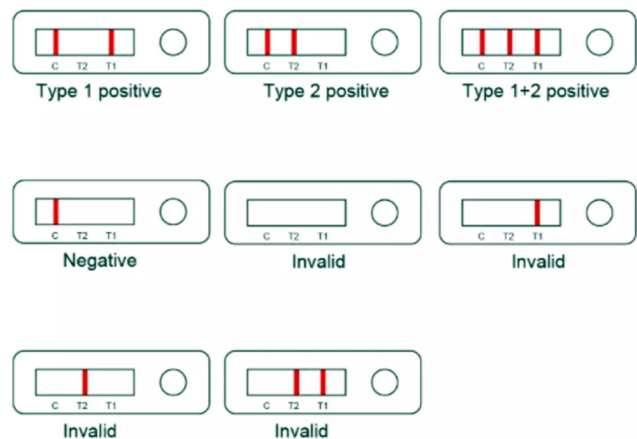

+632 82-TRULAB (878522)
+632 8287.3683
+63917.878.2288 • +63925.878.2288
www.trulaboratories.com