

## DENGUE

Dengue is a flavivirus, transmitted by aedes aegypti and aedes albopictus mosquitoes. It is widely distributed throughout the tropical and subtropical areas of the world, and causes up to 100 million infections annually. Classic dengue infection is characterized by a sudden onset of fever, intense headache, myalgia, arthralgia and rash.

### Test Procedure and Interpretation

#### Dengue Combo Test Cassette

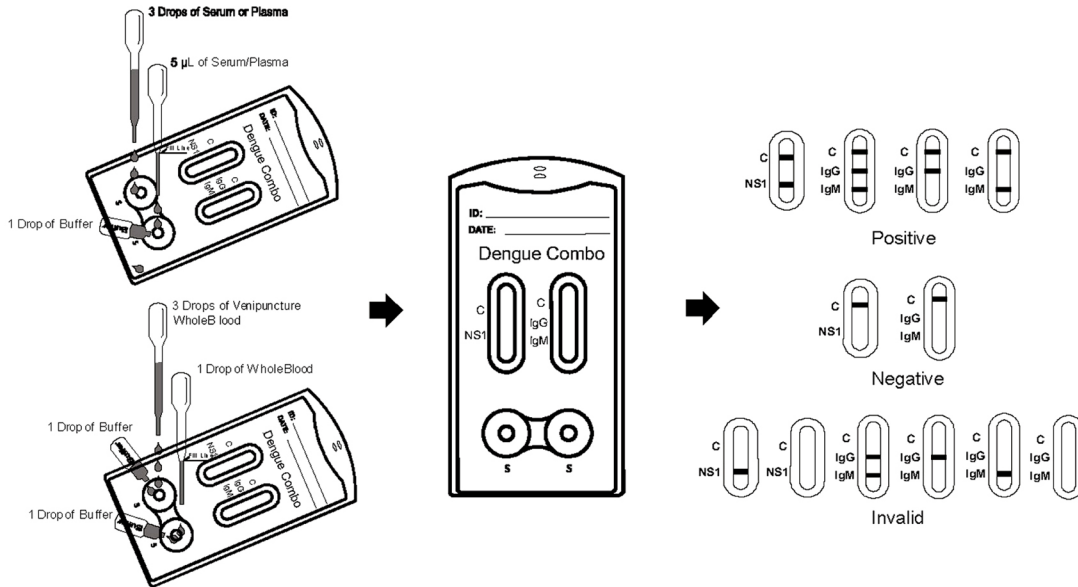

#### Dengue Test Cassette

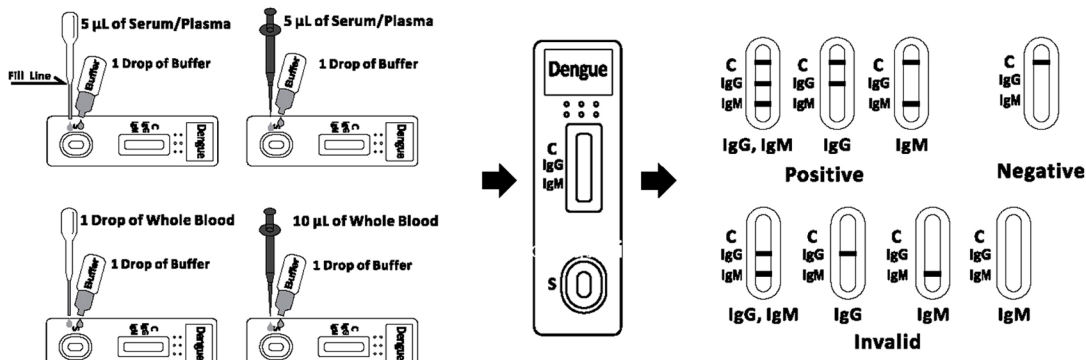

### ORDERING INFORMATION

PRODUCT	SPECIMEN	FORMAT	PACK
Dengue Combo Rapid Test Cassette	WB / S / P	Cassette	25T
Dengue Rapid Test Cassette	WB / S / P	Cassette	10T
Dengue NS1 Rapid Test Cassette	WB / S / P	Cassette	10T